

# How to create my FEI account on a FEI mobile application

FEIアカウントを作成する方法

You have never used your FEI ID number to log in to a FEI mobile application or FEI platform before?

You have never created a password for your FEI ID number?

To log in, you must first activate and create your account, this can easily be done via the FEI SportApp or FEI HorseApp.

If you have not downloaded the FEI mobile Apps please click here:

- **How to download and use the FEI SportApp (<https://howto.fei.org/content/4/73/en/how-to-use-the-fei-sportapp.html>)**
- **How to download and use the FEI HorseApp (<https://howto.fei.org/content/20/248/en/how-to-log-in-to-the-fei-horseapp.html>)**

**Step 1:** You are trying to log in but have not created your FEI account yet.

You must click on **Create my FEI account** or **Don't have an account? Create one.** 下記、どちらかをクリック

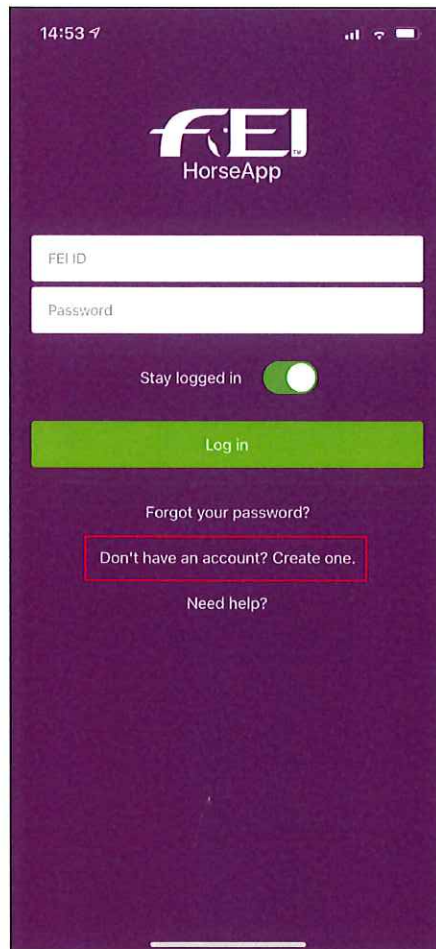
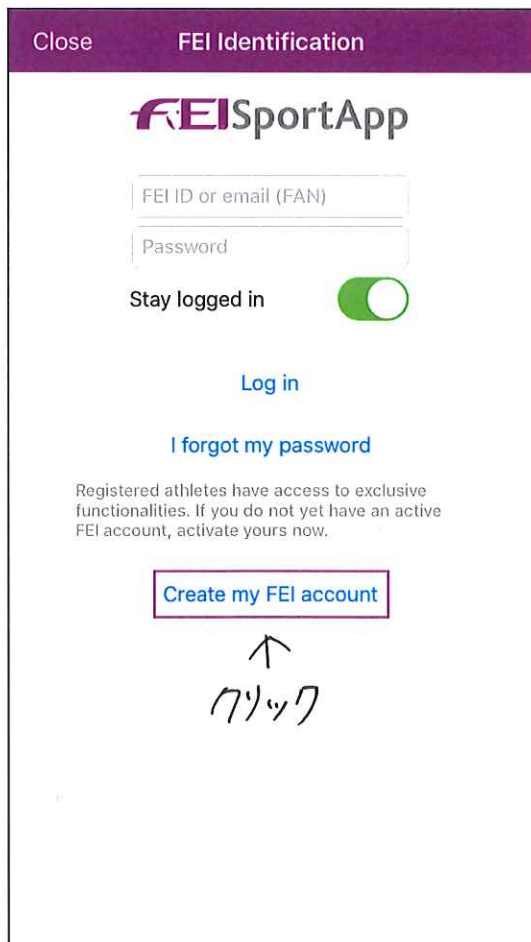

**Step 2:** You must select the group of people to which you belong and in which you are registered with the FEI.

自身のカテゴリーを選択する(「選手」、「グrooms」等)

If you belong to multiple groups, please choose the "main" one to which you are associated in regards to the FEI.

Close	Account Creation	Next
WHO ARE YOU ?		
FEI Athlete <input checked="" type="checkbox"/>		
FEI Official		
FEI Events Organiser		
Groom		
Trainer		
Owner		
Press		
Fan		
Help us know who you are by selecting the role or roles that define you best		

← クリック

選択

You must then click on **Next** in the top right corner.

**Step 3:** Fill in your personal details so that we can match you to a person on the [FEI Database](#) ().

The more information you provide us with, the easier it will be to find your profile and activate your account accordingly.

Account Creation Submit

PERSONAL INFORMATION

First Name Required

Family Name Required

Email Address Required

Date of Birth Optional

Competing for Optional >

I accept the FEI Terms and Conditions

Read the FEI Terms and Conditions

Account Creation Submit

PERSONAL INFORMATION

First Name John

Family Name Smith

Email Address john.smith@gmail.com

Date of Birth 27/10/79

Competing for Great Britain >

I accept the FEI Terms and Conditions

Read the FEI Terms and Conditions

入力  
 ※FEIデータベースに登録している内容と同じように入力する  
 承認

You must then click on **Submit** in the top right corner.

If the information you provide us with matches exactly the data we have for you on the FEI Database, an "account activation email" will be automatically sent to your email address.

FEIデータベースに登録されている内容と一致していることが認められた後、FEIから自動 X-14 (account activation email) が届きます。

**Step 4:** You will receive an automatic email from the FEI to activate your account - you must click on the link and follow the necessary steps to set up a password.

X-14 内にある リンクをクリックし、パスワードを設定する

Once you have set up your password, you will be able to log into the FEI SportApp, FEI HorseApp as well as other FEI IT platforms with your FEI ID number and newly created password.

パスワードを設定すると、アプリにログインできるようになります。

**Please note:** If the information you provide does not match what we have on the FEI Database, a message will be displayed on your mobile application screen. You can always click on "Cancel" and edit any information if you believe necessary.

If the information is correct, but our system cannot find you - please continue and an email will be sent to the FEI IT Support Team who will look into it as soon as possible.

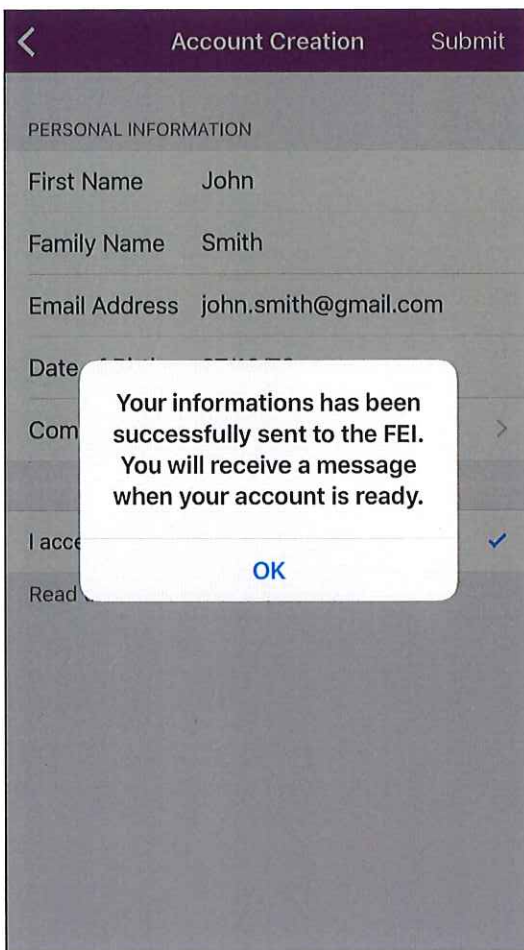

If the FEI IT Support Team can find you on the FEI Database, they will send you an automatic email and you can follow **Step 4** as mentioned above. If the FEI IT Support Team cannot find you, they will contact you accordingly to request further information.

FEIデータベースに登録している内容と一致なかった場合は、

アプリ上でこのように表示されます。「Cancel」を押して、内容を修正してください。

2021-04-16 09:59